

Cor-70 CC16 System with thermal break

A hinged 70 mm window system with a potent insulation capacity and with a transmission value from only 0,8 W/m²K which has been achieved thanks to the perfect combination and design of aluminium profiles, 35 mm tubular polyamide rods, E.P.D.M tubular water tightness gaskets and a system of polyolefine foam that is fitted around the glazing space perimeter.

Possibility of straight and chamfered sashes and straight, chamfered or curved beads.

With its large glazing capacity of 58 mm it presents to this system some excellent acoustic and thermal features allowing the use of large glazing thicknesses and energy efficiencies.

Allows for the possibility of incorporating hardware with concealed hinges.



Cor-70 CC16 System with thermal break

Transmittance

Uw from 0,8 (W/m²K)

Please consult typology, dimensions and glass

Acoustic insulation

Maximum glazing: 58 mm.

Maximum acoustic insulation **Rw=46 dBA**

Finishes

Possibility of dual colour

Colour powder coating (RAL, mottled and rough)

Wood effect powder coating

Anti-bacterial powder coating

Anodized

Categories achieved at test centre

Air permeability
(EN 12207:2000): Class 4

Water tightness
(EN 12208:2000): Class E1500

Wind resistance
(EN 12210:2000): Class C5
Reference test 1,23 x 1,48 m. 2 sashes



Sections

Frame 70 mm.

Sash 75 mm.

Profile thickness

Window 1,5 mm.

Door 1,7 mm.

Polyamide strip length 35 mm.

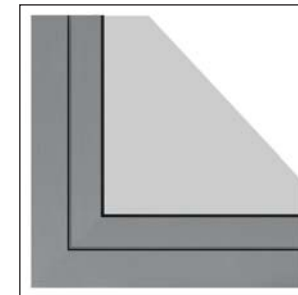
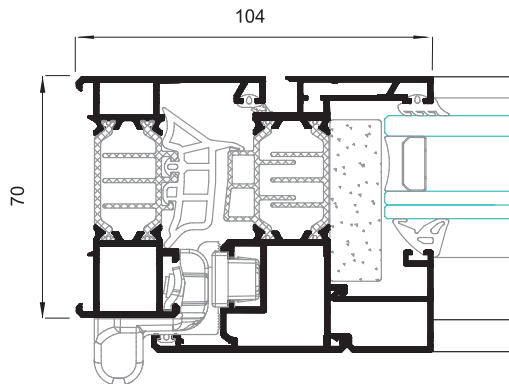

Opening possibilities

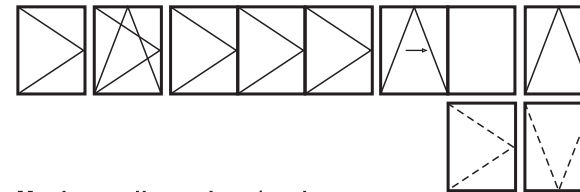

Open in: practicable, turn-tilt, folding, parallel tilt, hinged.

Open out: practicable, projecting-sliding.

Maximum dimensions/sash

Width (L) = 1.600 mm.

Height (H) = 2.800 mm.

Please consult regarding maximum weight and dimensions according to types

Maximum weight/sash

150 Kg.